



hush.
acoustics

Install Guide
Kite



Check the product page

Quiet by design

1. Locate the hardware and the Structure Support piece. Assemble in order as shown below.

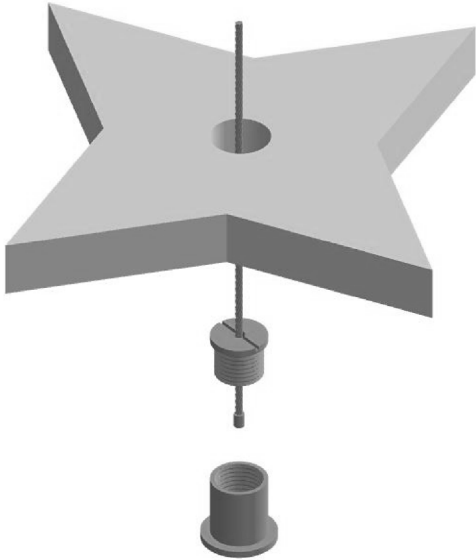

2. Now, with the Kite oriented exactly as shown, insert the hardware from the underside, pulling the cable through vertically.

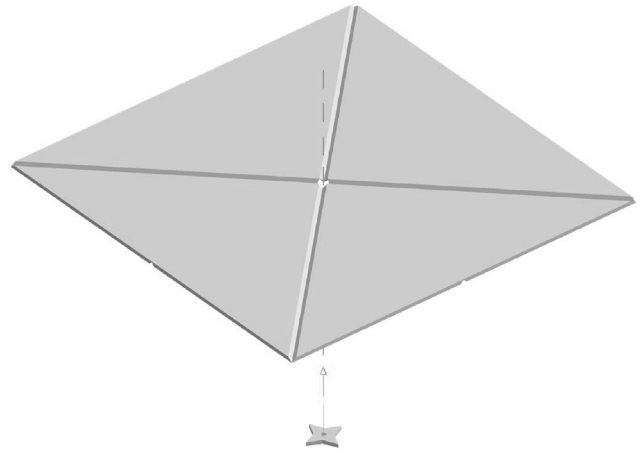

3. In this **underside** view, the Structure Support is shown in red to highlight how it must be aligned with the 'V' cut-outs on the underside of the Kite.

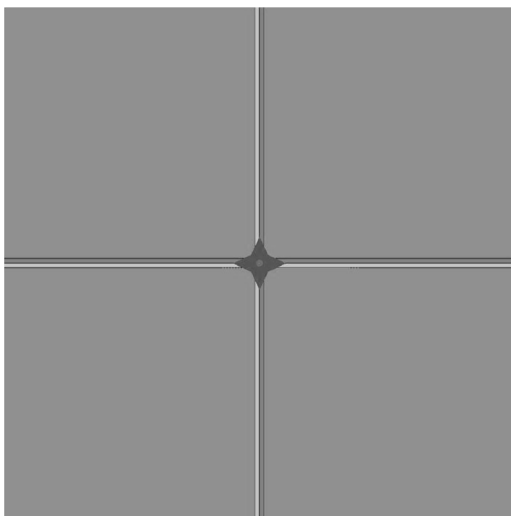

4. Now attach the suspension cable to the hardware mounted on your ceiling.

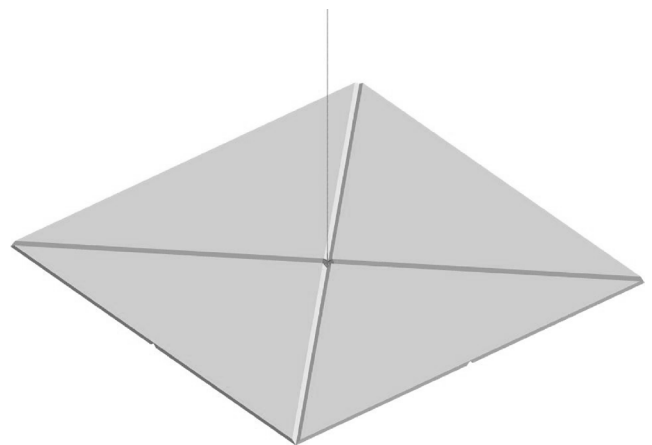

5. Once the cable has been suspended, the Kite will fold along the V-grooves. Ensure that the Kite has formed as shown below.

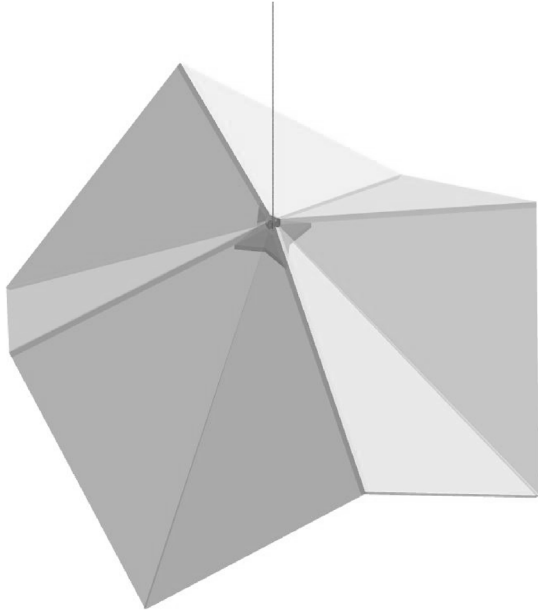

6. Your Kite installation is now complete.

